

ROBAN

Instruction manual

Scale Fuselage UH-1N

500 size



1. INTRODUCTION

Thank you for buying Roban Model products. The 500 size UH-1N scale fuselage is designed as an easy to use product. Please read the manual carefully before assembling the model, and follow all precautions and recommendations located within the manual. Be sure to retain the manual for future reference, routine maintenance and tuning. The scale fuselage is designed for T-REX 500 Helicopter series use. You can easily put it on your T-REX 500 for new clothing.

Important Note

Roban Model R/C Helicopters are advanced, high-performance devices, built incorporating the latest technologies. They are not intended as toys, and improper use can potentially lead to serious injury, or even fatal accidents. We implore you to read this manual thoroughly before operating these models. Safety should be your utmost priority - not just your own, but also that of others and your surroundings when piloting Roban Model products.

Liability Disclaimer:

The manufacturer and the seller cannot accept liability for the operation or misuse of this product. Roban Model R/C helicopters are intended to be used exclusively by experienced adults in legally sanctioned flying fields. Once sold, we cannot monitor or control the product's operation or usage.

Operation Guidelines:

ROBAN

Upon assembly of the scale fuselage, the weight and complexity of the structure will increase. To mitigate risk of accidents and damages, we advise against attempting 3D flights.

Skill Requirements:

The operation of R/C products necessitates a certain level of skill and familiarity. Any damages or dissatisfaction resulting from accidents, modifications, or operational mishaps are not covered under any warranty. Consequently, such products cannot be returned for repair or if you experience problems during operation or maintenance.

2. OPERATIONAL GUIDELINES FOR SAFETY IN USING R/C AIRCRAFT MODELS

Safety Zone:

Prioritize the safety of others by operating R/C aircraft models in isolated areas, free of bystanders. Avoid piloting these models near residential zones or large groups of people.

Operational Risks:

Be aware that R/C aircraft models are susceptible to accidents, malfunctions, and crashes. These may result from a range of factors such as inadequate maintenance, pilot errors, or radio interference. Understanding these risks is crucial for safe operation.

Pilot Responsibility:

Pilots bear the sole responsibility for any damage or injuries that may occur during operation or as a result of using R/C aircraft models. By undertaking the control of these devices, you accept accountability for your actions and their possible consequences. Always aim for caution and responsible handling to minimize any potential risks.

ROBAN

3. CONTENTS OF KIT

Please check the contents of the kit prior to installation.

Lieferumfang:

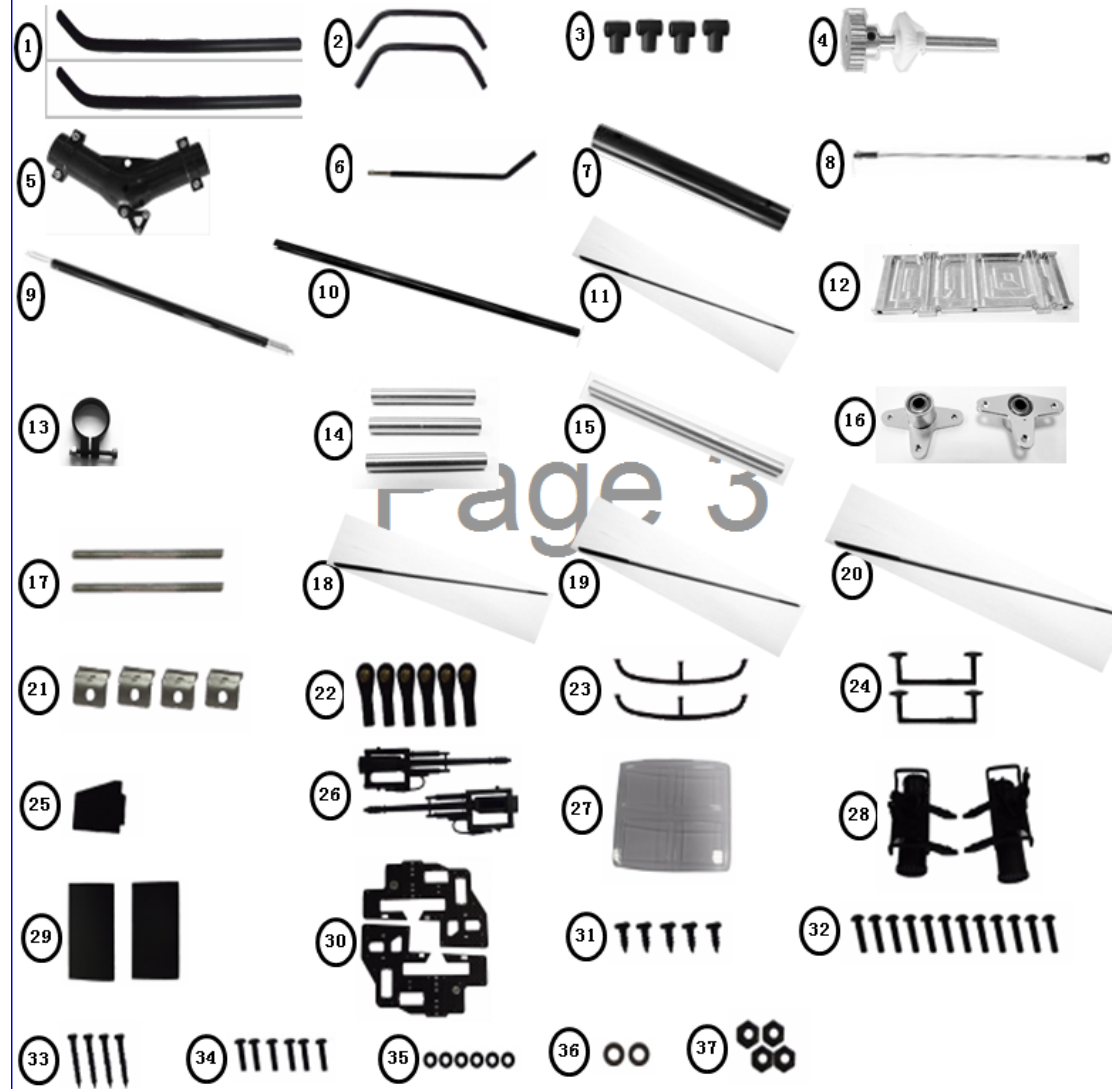

CONTENTS

Item No.	Description	Quantity
1	Landing gear skins	x2
2	Landing gear struts	x2
3	T-connectors	x4
4	Redirection gearbox	x1
5	Rear redirection	x1
6	Tail skid	x1
7	Tail tube	x1
8	Servo linkage	x1
9	Tail shaft	x1
10	Tail tube	x1
11	Servo linkage	x1

ROBAN

12	Base plate	x1
13	Tail tube holder	x1
14	Spacers	x3
15	Spacer	x1
16	T-lever	x2
17	Linkage 45mm	x2
18	Linkage 90mm	x2
19	Linkage 179mm	x1
20	Linkage 425mm	x1
21	Bracket	x4
22	Ball joint connectors	x6
23	Antenna	x2
24	Antenna	x2
25	Antenna	x1
26	Machine guns	x2
27	Glass set	x1
28	Rocket launcher	x2
29	Tail unit	x2
30	Side frame	x2
31	Screw A2x5	x5
32	Screw M2.5x10	x12
33	Screw A2x14	x4
34	Screw M2x8	x6
35	Washer M5	x6
36	Washer M6	x2
37	Nut M2	x4

REQUIRED TOOLS / CONSUMABLES

Tool No.	Tool/Consumable
1	Hobby knife
2	Allen wrench
3	Phillips screwdriver
4	File
5	Side cutters
6	Silicone adhesive
7	Super glue
8	2K Epoxy glue
9	Fine sandpaper
10	Scissors

ROBAN

4. INSTALLATION

- 4.1 Mount the struts with Screw A2x14 as shown.



- 4.2 Install the T-connectors as shown.



- 4.3 Install the skids as shown

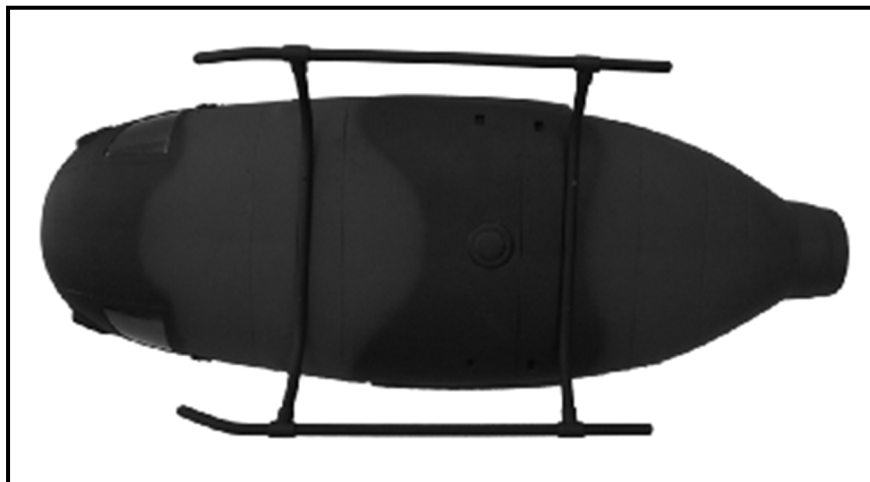

ROBAN

- 4.4 Mount the side frames, base plate, and mounting blocks as shown.

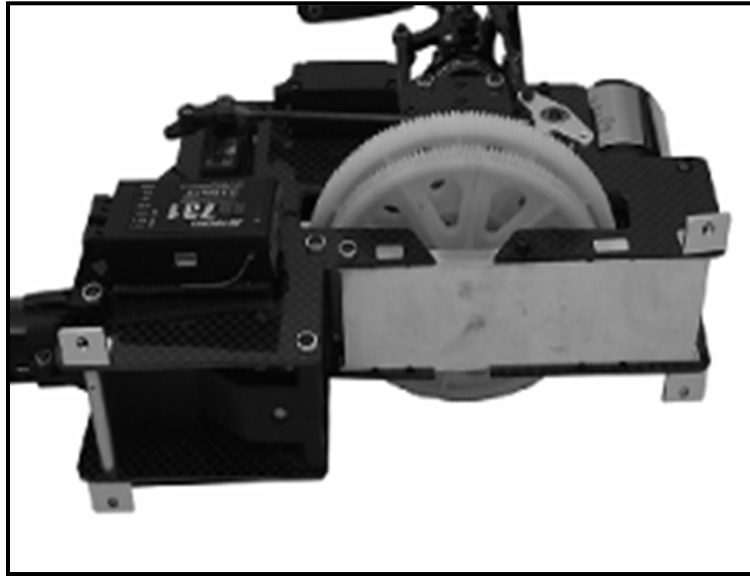

- 4.5 Install the tail struts as shown.



- 4.6 Install the rear redirection and the linkage as shown.



ROBAN

- 4.7 Install the tail servo and adjust the tail linkage and servo.

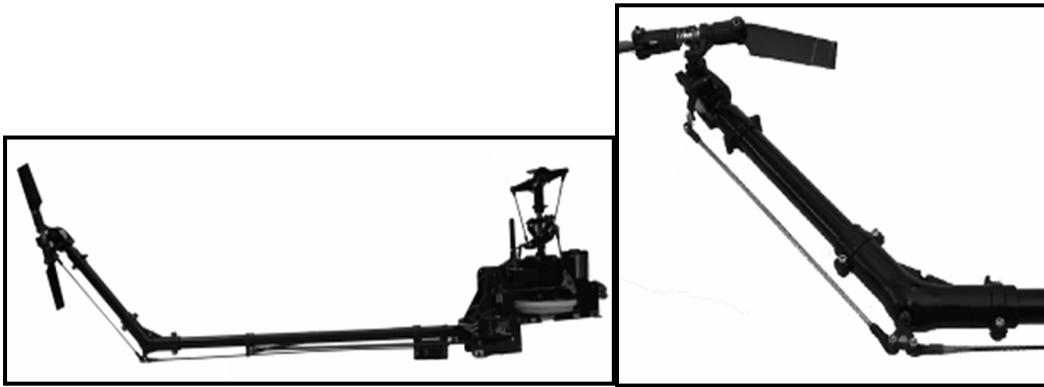

- 4.8 Then dismantle the tail rotor and linkage as shown for installation.



- 4.9 Insert the mechanics into the fuselage as shown.



ROBAN

4.10 Open the tail cover.



4.11 Slide the tail onto the tail tube.



4.12 Install the tail propeller.

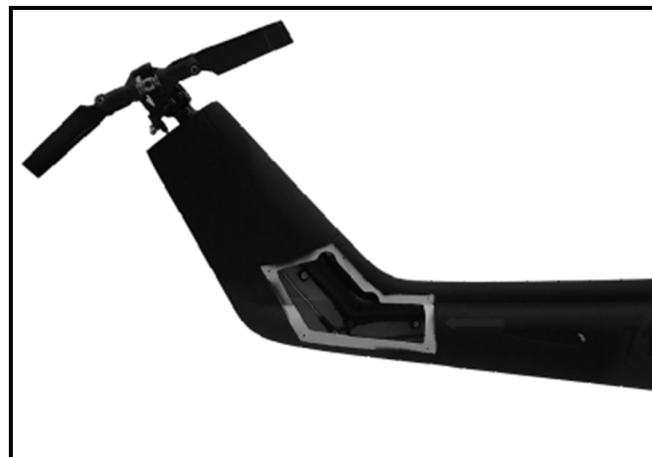

ROBAN

4.13 Screw the mechanism using the brackets (17) as shown.

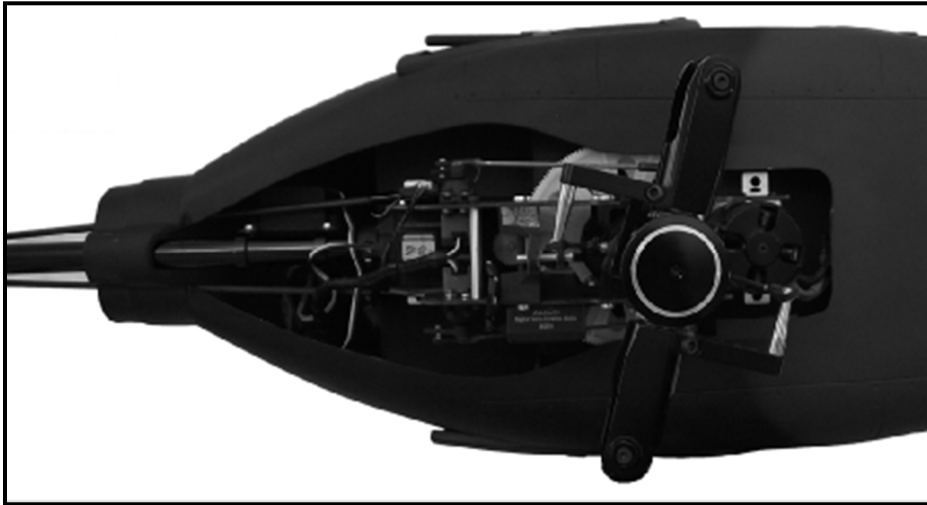

4.14 Install the tail cover.



4.15 Screw the tail as shown, using the washers.

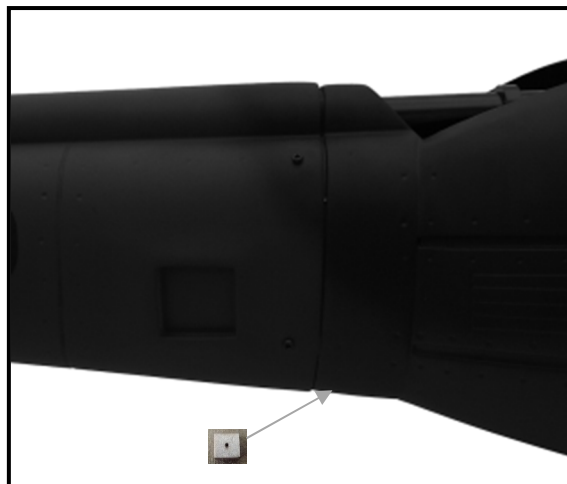

ROBAN

4.16 Dismantle the doors.



4.17 Pre-assemble the cockpit as shown.

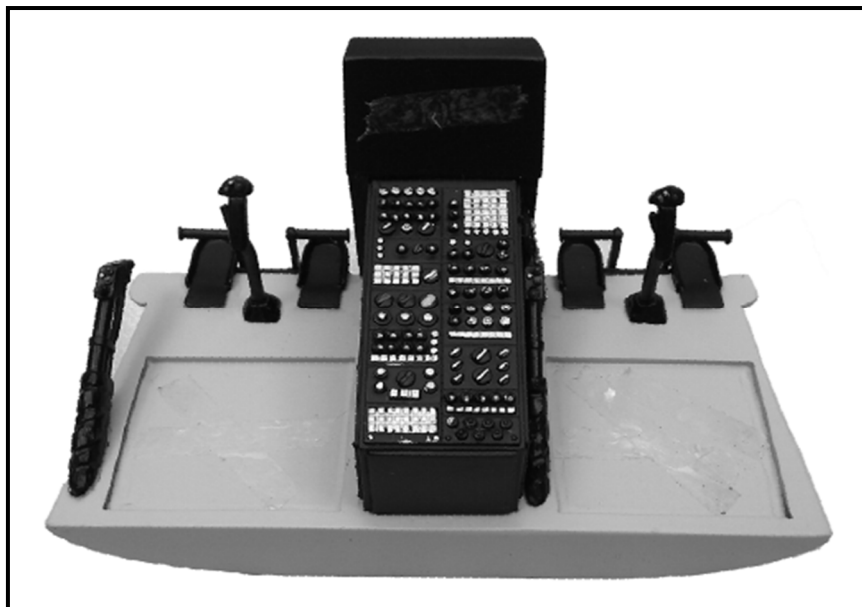

4.18 Insert the cockpit through the rear door and glue it.



ROBAN

4.19 Then glue the large dashboard.



4.20 Then glue the pilot seats. Reassemble the doors.



4.21 Glue the tail units as shown.



ROBAN

4.22 Glue the antennas in as shown.

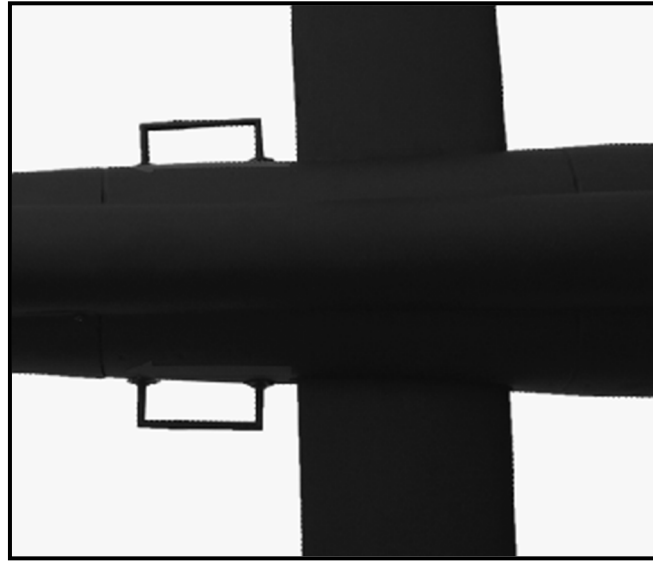

5. SPAREPART LIST

UH500APJ001		500UH1 前头	500 UH-1A canopy
UH500APJ002		500UH1 前窗	500 UH-1A front window
UH500APJ003		500UH1 全套 窗	500 UH-1A all windows
UH500APJ004		500UH1 平尾	500 UH-1A tail wings
UH500APJ005		500UH1 脚架 组	500 UH-1A landing gear
UH500APJ006		500UH1 尾波 箱	500 UH-1A elevated tail set
UH500APJ007		500UH1 水印	500 UH-1A decals

ROBAN

6. FULLY ASSEMBLED FUSELAGE



Specifications:

Length: 1150mm

Height: 280mm

Width: 3300mm

Weight: 1500g

Suitable for Align TREX500ESP and derivatives



We wish you a lot of fun with the fuselage!

ROBAN

Copyright 2024 – www.robamodel.com